

Heavy-duty Crank Control Roller Blind

Fitting, operation and maintenance instructions

Warning! The operating instructions must be read before operating the blind.

Fitting Instructions for Heavy-duty Crank control Roller Blinds

This procedure can be completed by non-professionals.

Step 1 - Identify and position the brackets

Ensure that each bracket is correctly matched and positioned to correspond with the Idle End and Crank Control End of the blind. The Crank mechanism is supplied attached to the bracket.

Use the same measuring reference points taken when determining the blind's width - you may also use the blind itself as a fitting template.

When installing inside the recess, ensure the brackets are set far enough away from any window handles or obstructions to allow the blind to move freely. Finally, allow just enough clearance for the blind to fit neatly and securely between the brackets.

Step 2 - Mark, drill, and secure the brackets

If necessary, mark the screw positions by pencil through the bracket slots. Drill and plug the holes as required, then fix the brackets securely using appropriate fittings. (Please note that screws and fixings are not supplied).

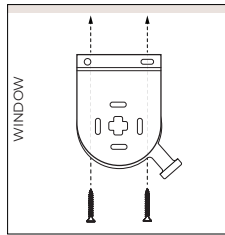

Single Bracket | Top Fix

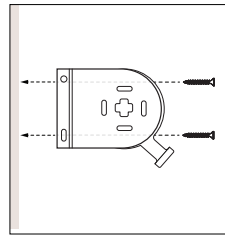

Single Bracket | Face Fix

Step 3 - Fit the bracket covers

Once the brackets are secured, attach the bracket covers to fully conceal the fittings. The covers should be used for both, inside or outside the recess installations.

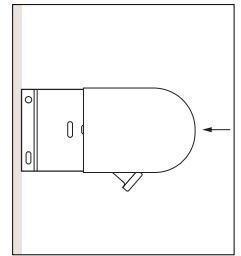
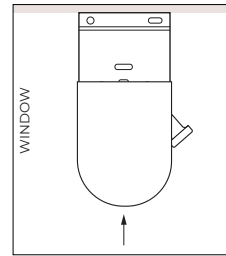

Step 4 - Install the blind into the brackets

Remove the blind from its packaging. Insert the metal pin end into the square slot of the crank mechanism attached to the bracket, then insert the plastic pin end into the round hole of the idle end bracket.

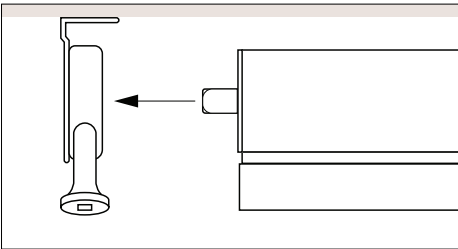

Step 5 - Attach crank handle

Remove the retaining fabric strip holding the blind in place. The blind is supplied with a crank handle - attach this to the magnetic handle connector on the crank mechanism. See the operating instructions on the next page.

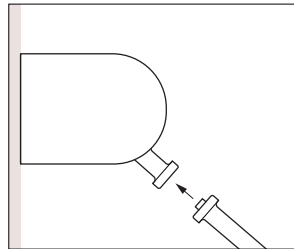

Fitting Instructions for Roller Blinds with Back Bar

This procedure can be completed by non-professionals.

Step 1 - Install the brackets

The blind is supplied pre-fitted to the back bar. Position the supplied top-fix brackets at least 50 mm from each end of the blind and spaced no more than 500 mm apart, using appropriate fixings for your surface. Ensure the lip of each bracket is facing toward the window.

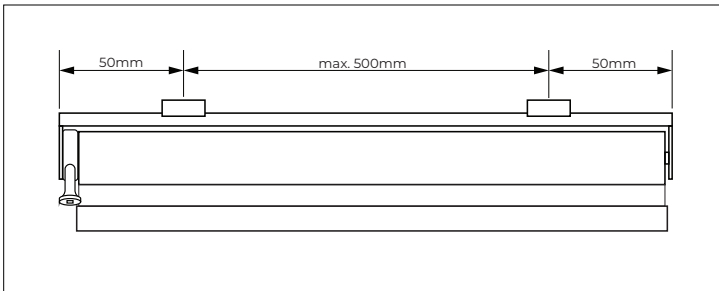

Step 2 - Secure the back bar

Fit the back bar into the installed brackets, making sure the back edge of the back bar fully clips and locks into place within each bracket.

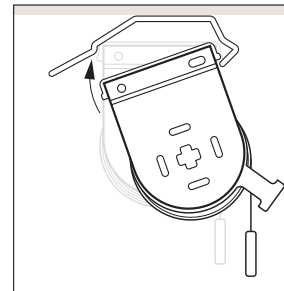
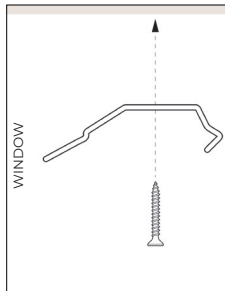

Step 3 - Attach crank handle

Remove the retaining fabric strip holding the blind in place. The blind is supplied with a crank handle - attach this to the magnetic handle connector on the crank mechanism. See the operating instructions on the next page.

Operation & Maintenance

Warning! The operating instructions must be read before operating the blind.

Operating instructions - Standard roll (Fabric unrolls from behind blind)

1. Attach the handle to the magnetic connector on the crank mechanism.
2. Turn the handle clockwise to lower the blind.
3. Turn the handle counter-clockwise to raise the blind.

Operating instructions - Reversed roll (Fabric unrolls from front of blind)

1. Attach the handle to the magnetic connector on the crank mechanism.
2. Turn the handle counter-clockwise to lower the blind.
3. Turn the handle clockwise to raise the blind.

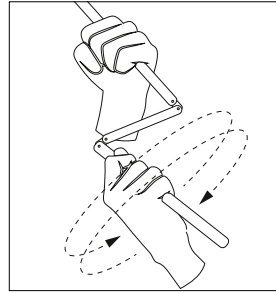

Maintenance Instructions

This product is designed to be maintenance-free; however, we recommend carrying out regular visual inspections to ensure that no components are damaged, as this could lead to operating difficulties or pose a safety risk. If any maintenance is required, it should be completed promptly by a reputable blind company.

For light cleaning, gently wipe or dust the fabric with a soft brush or duster.

For safety and performance, do not make alterations to the blind, chain, or safety device.